

5.DULAP TIP 160

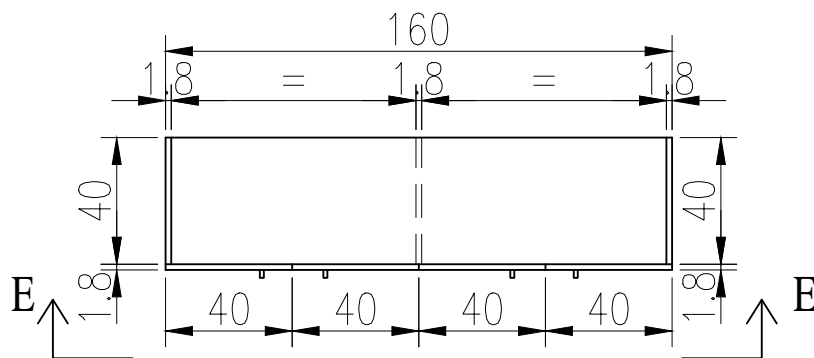

Sectione E-E

6.DULAP TIP D160

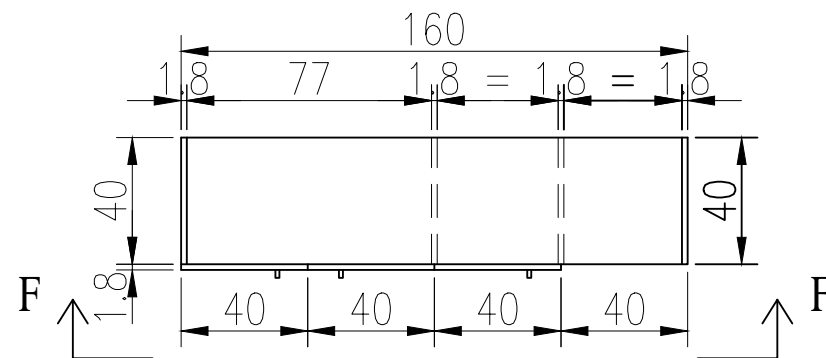

Sectione E-E

7.DULAP TIP 105

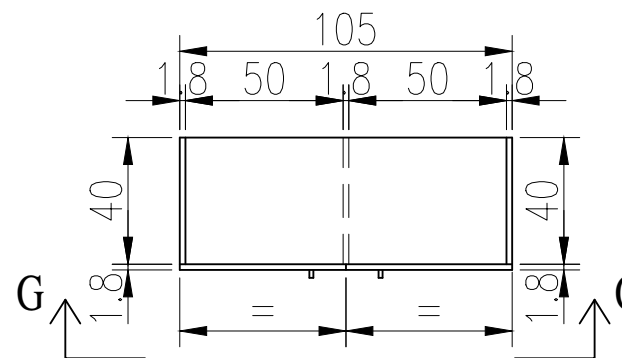

Vedere G-G

8.DULAP TIP D105

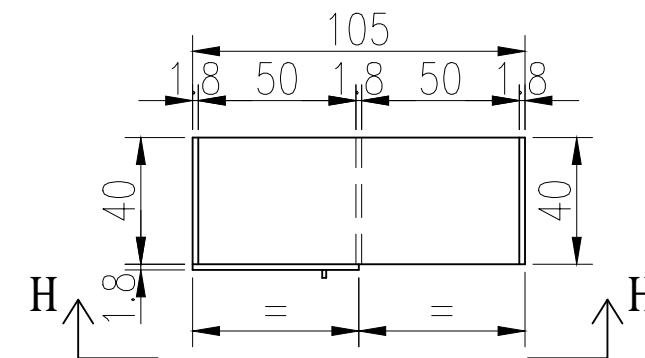

Vedere H-H

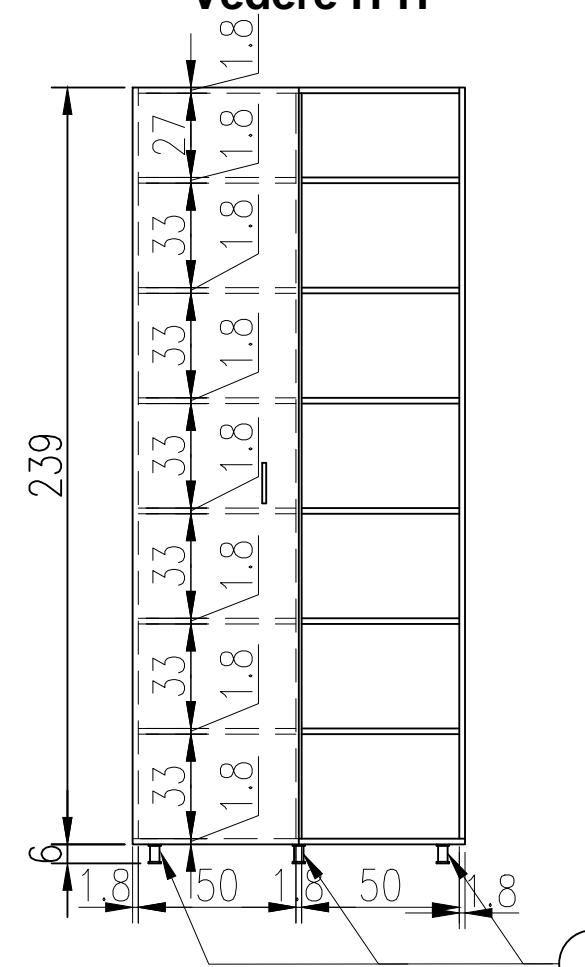
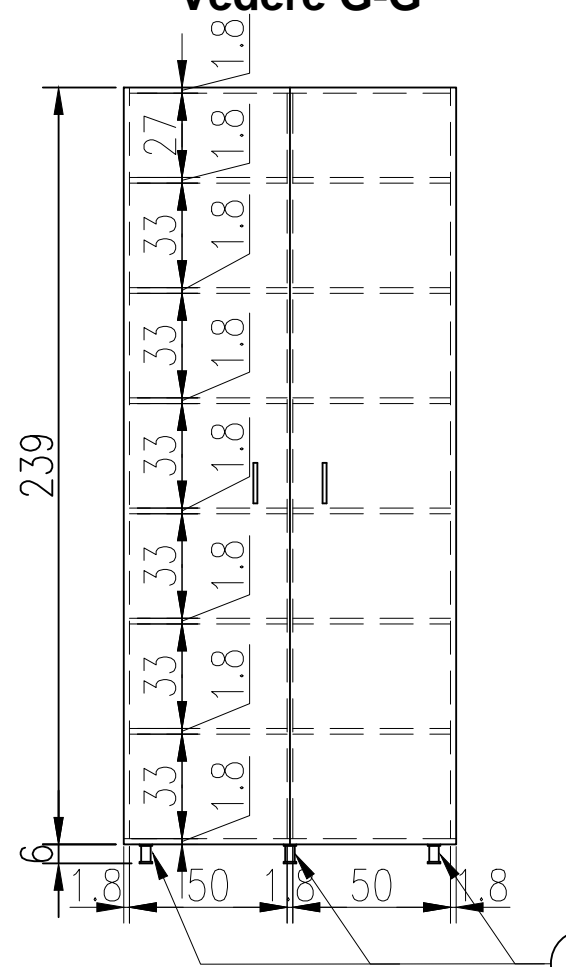
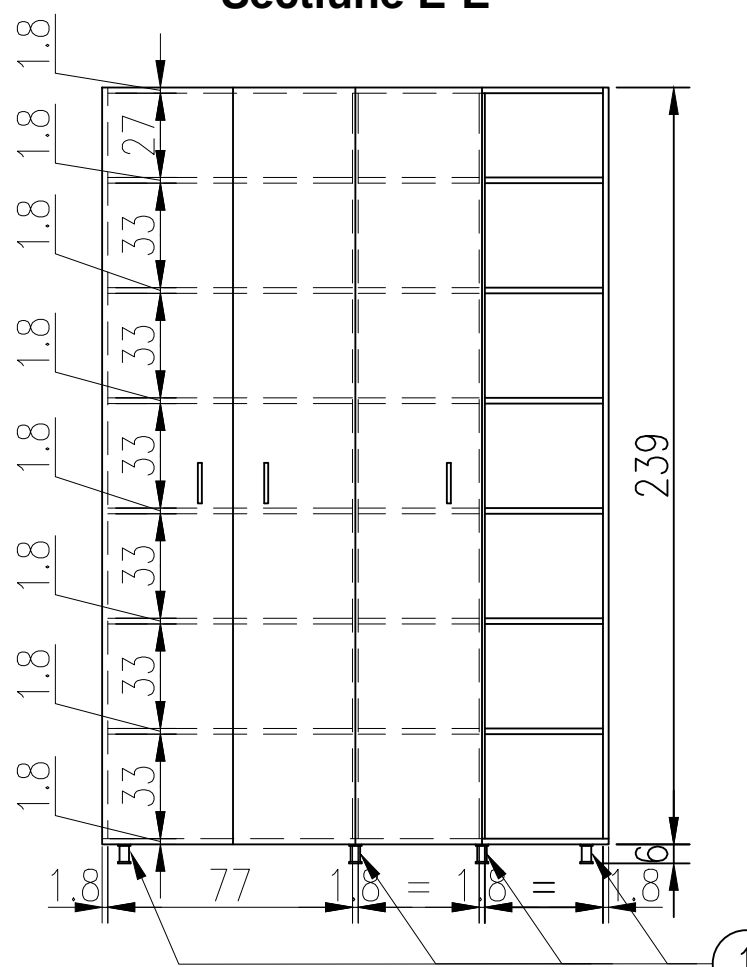
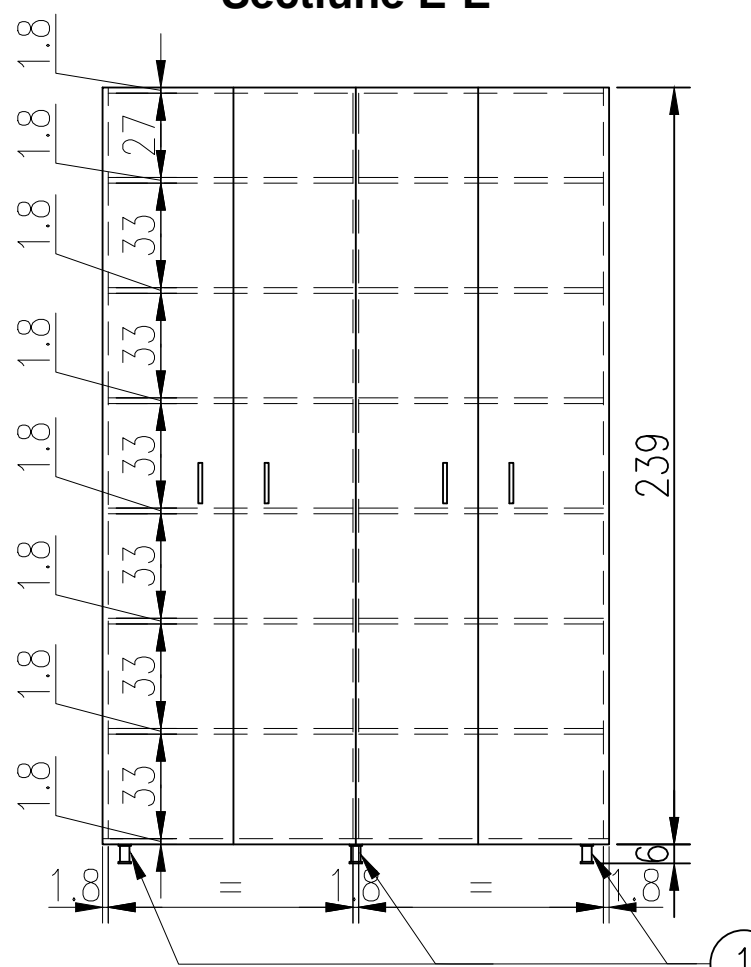

① picioruse aluminiu reglabile; $h_{max}=6$ cm; sectiune min. $\varnothing 40$ mm/min. 40x40mm